



**Pilous**

Železná 9, 619 00 Brno, Czech Republic

Tel.: +420 543 25 20 10

e-mail: [wood@pilous.cz](mailto:wood@pilous.cz), [www.pilous.cz](http://www.pilous.cz)

## CTR 750 EV



máx. (mm)		
		
750	640	530 x 530

4140 x 34-35 x 0,9-1,0 mm

Max. log diameter	750 mm
Max. opening between blade guides	640 mm
Max. elevation of blade	620 mm
Min. log height	25 mm
Max. depth of cut	255 mm
Max. log length (standard model)	3,45 m
Length track section	2,25 m
Min. log length	0,75 m
Saw blade motor	5,5 kW
Horizontal/vertical feed motor	0,37/0,37 kW
Max. feed speed (forw/back)	15 m/min.
Sawblade	4140 x 34 x 1,1 mm
Weight (standard model)	445 kg
Weight (track section)	70 kg

**Nominal current of circuit breaker is minimally 16 Ampere**

## DESCRIPCIÓN DEL PRODUCTO

**Feed into the cut and back - motor-powered**

**Arm height adjustment - motor-powered**

**Control panel - on a mobile bridge**

**Log handling - manual**

The bigger and stronger version of the popular CTR 550 allows for processing of logs up to 75 cm in diameter. Ideal solution for family farms or small sawmilling companies.

The height adjustment of the sawmill arm is done by a chain transmission driven by an electric motor with a worm gearbox. The desired cutting thickness can be simply set on the touch screen with the option of setting the required kerf width. The movement of the arm, controlled by a frequency inverter with deceleration in the end positions, guarantees precise automatic setting to the desired values. Simple, intuitive operation on the 3.8-inch colour touch screen controlled by a new-generation operating system. Allows a choice of four programming cutting modes. It is possible to set the repetition of a constant or variable thickness of lumber. It is also possible to choose between two methods of automatic arm exit after the cut, either to a fixed height or by the last measure.

The movement into and out of the cut is provided by a worm-gearbox electric motor controlled by a frequency inverter. The travel speed can be changed simply by turning the potentiometer knob on the control panel. The end positions are secured against impact by automatic deceleration and stopping. The control panel is mounted on the travelling bridge of the sawmill arm. This allows closer contact between the operator and the material to be cut during cutting.

The solidly mounted drive wheel is driven via a V-belt by a professional electric motor, specially balanced against vibration. The basic version of the machine is equipped with a powerful 5.5 kW motor. For even higher performance, for example when cutting oversized logs or even when cutting very hard materials, a 7.5 kW motor can be used. The machine's total input power of 6.95 kW (the more powerful 7.5 kW motor has a total input power of 8.95 kW) guarantees low running costs and easy connection to the mains. Circuit breaker 16 A (25 A for the 7.5 kW motor).

The tensioning wheel system moves in a cast iron guide, which guarantees long service life and precision adjustment even with long-term use of the machine. The arm is fitted with aluminium running wheels with precise anti-vibration balancing. The circumference of the wheel has a recessed groove in which a replaceable rubber-textile V-belt is fitted, which forms the contact surface between the wheel and the saw blade.

The stability of the machine is based on very solid steel travel sections, which ensure optimum guidance of the sawmill arm bridge. The travel sections are fitted with tilting angle bars and log clamps/cam dogs.

The sawmill CTR 750 EV uses standard saw blades 34-35 x 0,9-1,0 mm as with the fully professional models.

The CTR model series represents the latest trends in sawmill design, with special emphasis on maximum accuracy and long service life at minimum cost. The machines are designed in an original modular way, which allows easy replacement or adjustment of all main technical nodes and their individual parts. This significantly reduces maintenance costs in the long-term use of the machine and also reduces service times, thus reducing production downtime.

All pictures shown are for illustration purpose only. Actual product may vary due to product enhancement.

## GALERÍA DE IMÁGENES

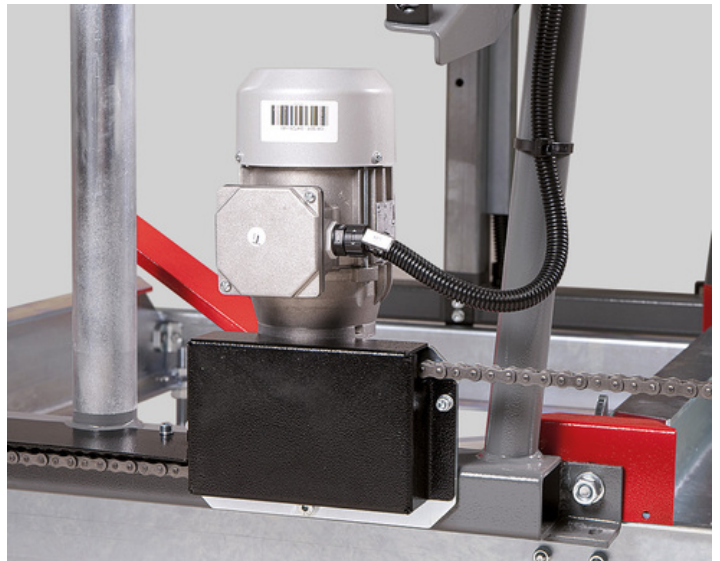
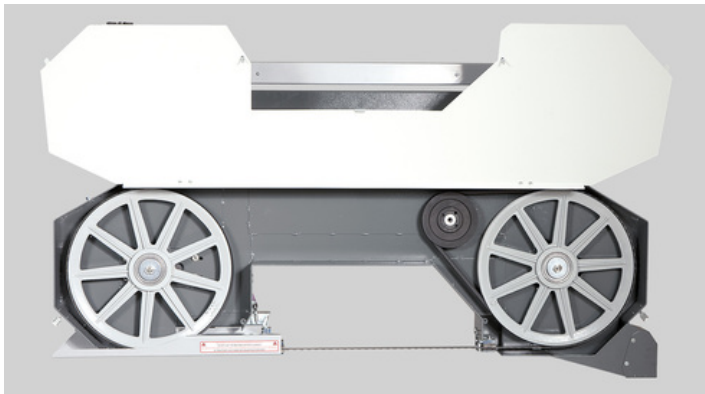

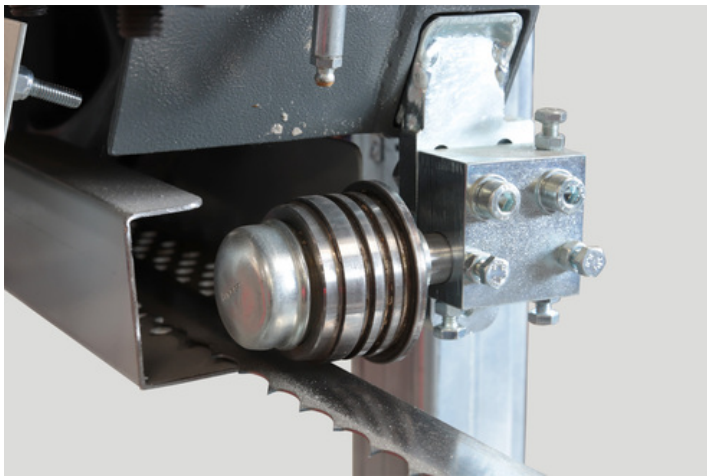
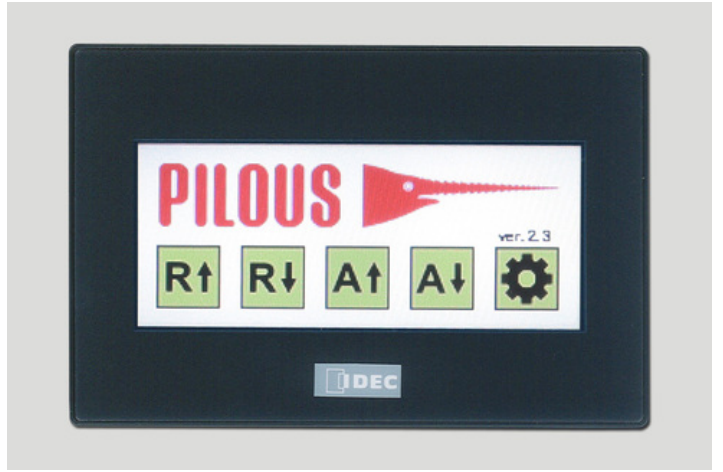



## ACCESORIOS

### ACCESORIOS – SPECIAL ACCESSORIES



2,25 m

**Extending section  
2,25m**

#### **Extending section 2,25 m**

Include: 3x Cross beams, 1x Tilting angle bar, 1x Clamp  
Variable points: 1x Tilting angle bar, 1x Clamp



**Main motor 7.5 kW**

#### **Main motor 7.5 kW**

For even higher performance, for example, when cutting oversized logs or even when cutting very hard materials, especially with Stellite-tipped blades 7.5 kW motor can be recommended.



**Saw blade tension  
indicator**

#### **Saw blade tension indicator**

Ensures accurate tensioning of the saw blade to a required value according to the pressure gauge and its control during the use of the machine. Optimum tensioning of the saw blade is essential for its service life and cutting accuracy.



**START/STOP  
cooling system**

#### **START/STOP cooling system**

Integrated in the cooling system is an electromagnetic through-flow valve, which automatically opens when the saw blade is started and closes when the saw blade is stopped. It substantially lowers the coolant consumption and saves time needed for replenishment of coolant liquid.



**Cant hook**

#### **Cant hook**

Serves as help with manipulation with logs on machine frame.



**Clamp with tilting  
angle bar**

#### **Clamp with tilting angle bar**

Additional clamping kit. It consists of the clamp and a tilting angle bar.



**Additional clamp**

#### **Additional clamp**



**Cam dog**

#### **Cam dog**

For fast and easy squared lumber clamping.



**Grease Gun**

#### **Grease Gun**

For regular maintenance of the machine according to the lubrication plan. Metal grease gun for 400g tubes. Equipped with a flexible pressure hose.



**Synthetic Grease LV  
2-3**

#### **Synthetic Grease LV 2-3**

400g tube for the grease gun.

### ACCESORIOS – CONSUMABLE PARTS



**Running Wheel V-  
belt SPB 1850  
Driven Wheel V-belt  
17x1560 Lw**

**Running wheel wedge belt SPB  
1850  
Wheel wedge belt B 17x1560 Lw**

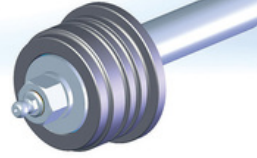

**Blade Roller Kit VK  
750**

**Blade Roller Kit VK 750**  
Hardened roller, bearings, and shaft  
designed for a sawmill blade 35 mm.



- The original sawmill blades PILOUS MAXwood are available in a variety of types which enables you to process any kind of wood.
- The wide product range not only offers more affordable sawmill blades for low-volume cutting, but includes also sawmill blades for fully professional cutting and utmost performance.
- The foundation of all sawmill blades are top-quality German materials and precise workmanship. The quality of the sawmill blades is carefully monitored. All sawmill blades correspond to the strict ISO 9001 norm.
- We have added to our portfolio also an original Munkfors sawmill blade made by the world's leading manufacturer Uddeholm from Sweden.
- Pilous sawmill blades are used in dozens of countries around the world. Any wood you cut, the company Pilous will recommend you a sawmill blade that will fit your needs.

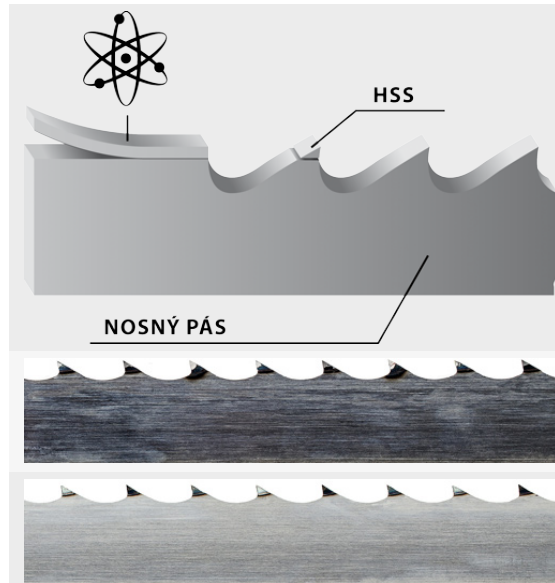

### BiMetal

Sawmill blade with tool steel teeth - completely eliminates the need to sharpen the sawmill blade as well as frequent blade replacement. Use: soft, hard to extremely hard wood.

### HSS

Bearing blade

### Stellite

Sawmill blade with teeth made of Stellite. Tooth setting is completely unnecessary. Use: soft, hard to extremely hard wood.

### Carbon spring steel

The most common sawmill blade for optimum price/performance ratio. Use: soft and hard wood.



Be careful when unpacking welded sawmill blades. They are in a shipping container in tensioned condition. Remove the sawmill blade cover only after fitting it onto the machine.

