



Pilous

Železná 9, 619 00 Brno, Czech Republic

Tel.: +420 543 25 20 10

e-mail: metal@pilous.cz, www.pilous.cz

CTR 800

4920 x 35-40 x 0,9-1,1 mm



Max. log diameter	830 mm
Max. opening between blade guides	750 mm
Max. elevation of blade	685 mm
Min. log height	25 mm
Max. depth of cut	450 mm
Max. log length (standard model)	1,8 m
Length track section	3 m
Min. log length	1 m
Saw blade motor	7,5 (11, 15) kW
Horizontal feed motor	0,55 kW
Vertical feed motor	0,55 kW
Sawblade	4380 x 35÷40 x 0,9÷1,1 mm
Weight (standard model)	750 kg
Weight (track section)	131 kg

Nominal current of circuit breaker is minimally: 7,5/11 kW - 32 Ampere; 15 kW - 50 Ampere

DESCRIPCIÓN DEL PRODUCTO

Feed into the cut and back - motor-powered
Arm height adjustment - motor-powered
Control panel - on a mobile bridge
Log handling - manual

Universal sawmill which is, with its maximum cutting diameter of 830 mm, suitable for most lumber.

A wide, exceptionally massive bridge of the sawmill arm and robust running sections ensure undisturbed operation when cutting and even at high running speeds. Professional execution of all main technical units, such as running wheels with their bearing system, sawmill arm construction, powering and feeding system, etc. ensure maximum service life and machine accuracy even under the most difficult operating conditions.

The movement into and out of the cut is provided by a worm-gearbox electric motor controlled by a frequency inverter. The travel speed can be changed simply by turning the potentiometer knob on the control panel. The end positions are secured against impact by automatic deceleration and stopping. The control panel is mounted on the travelling bridge of the sawmill arm. This allows closer contact between the operator and the material to be cut during cutting.

The basic version of the machine is equipped with a powerful 7.5 kW motor. For even higher performance, for example when cutting oversized logs or even when cutting very hard materials, especially with Stellite-tipped blades a 11 or 15 kW motor can be used.

The massive sawmill arm is borne on adjustable hard-chromium rods (for moving up and down) which ensure absolute accuracy of sawmill arm movement and virtually unlimited service life, if the machine is lubricated regularly. The vertical movement of the arm is provided by double-sided synchronous chain transmission powered by an electric motor with worm gearbox.

The desired cutting thickness can be simply set on the touch screen with the option of setting the required kerf width. The movement of the arm, controlled by a frequency inverter with deceleration in the end positions, guarantees precise automatic setting to the desired values. Simple, intuitive operation on the colour touch screen controlled by a new-generation operating system allows a choice of four programming cutting modes. It is possible to set the repetition of a constant or variable thickness of lumber. It is also possible to choose between two methods of automatic arm exit after the cut, either to a fixed height or by the last measure.

The arm is fitted with running wheels made of high-quality grey cast iron with accurate balancing against vibrations. The wheel has a groove along its circumference. The groove holds a replaceable rubber-textile belt which creates an optimum contact area between the wheel and the saw blade.

The sturdily mounted running wheel is powered through a V-belt by a professional electrical motor specially balanced against vibrations.

The tensioning wheel system moves along a sturdy cast iron dovetail slide with screws and a bar for fine-tuning, which allows highly accurate adjustment without any free travel even in long-term machine operation.

Stable running sections with steel bridge guides form the basis of the machine. They are sufficiently dimensioned for the maximum diameters of logs as well. They were designed reflecting the practice, therefore designed to cope with very hard operating conditions. The log length is virtually unlimited, it only depends on the number of installed running extending sections. Running sections are fitted with massive, height-adjustable log-bearing beams and adjustable tilting angle bars, and cam dogs/log clamps.

The CTR model series represents the latest trends in sawmill design, with special emphasis on maximum accuracy and long service life at minimum cost. The machines are designed in an original modular way, which allows easy replacement or adjustment of all main technical nodes and their individual parts. This significantly reduces maintenance costs in the long-term use of the machine and also reduces service times, thus reducing production downtime.

A wide range of accessories simplify and accelerate machine operation and influence its production. It is therefore possible to adapt the sawmill exactly according to the needs of the customer.

All pictures shown are for illustration purpose only. Actual product may vary due to product enhancement.

GALERÍA DE IMÁGENES

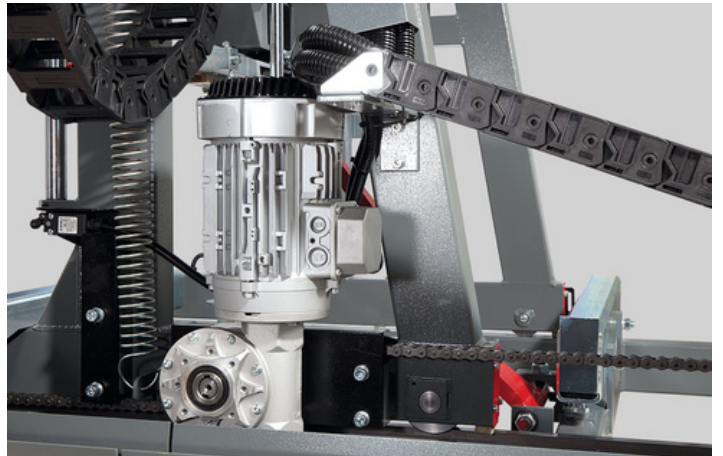
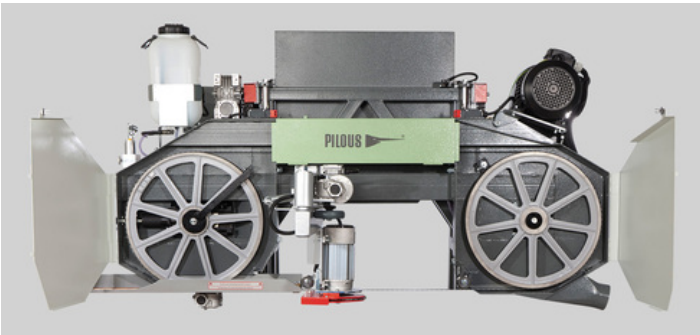
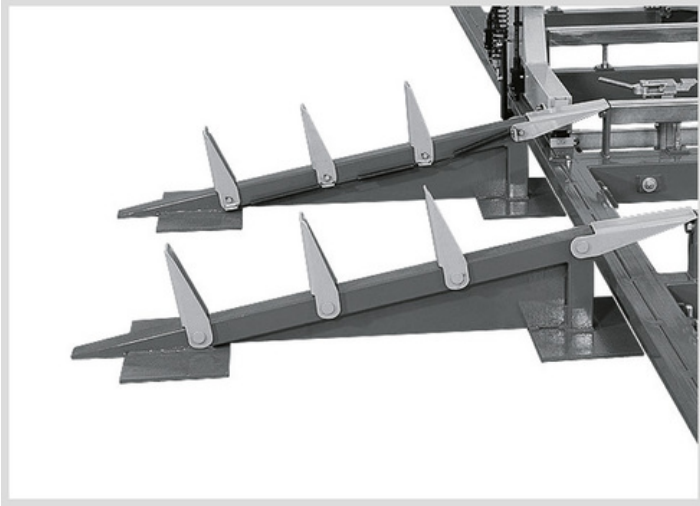

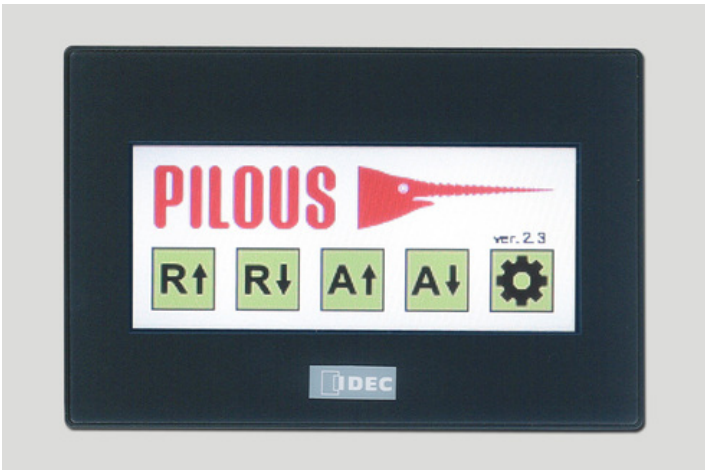
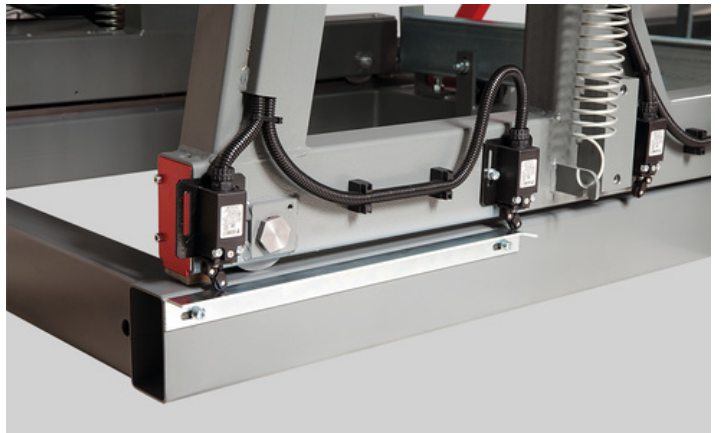
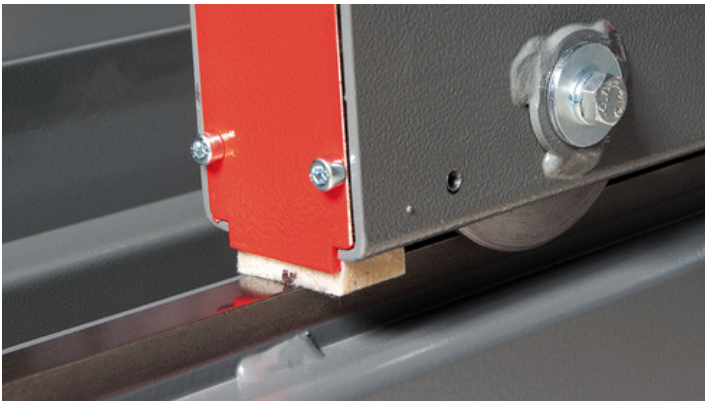
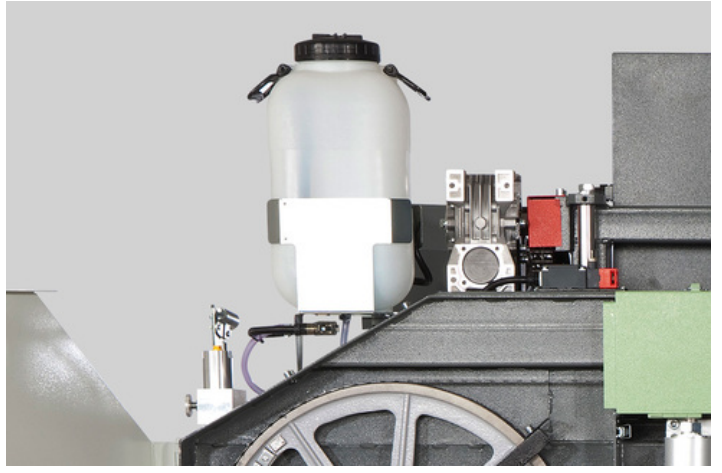
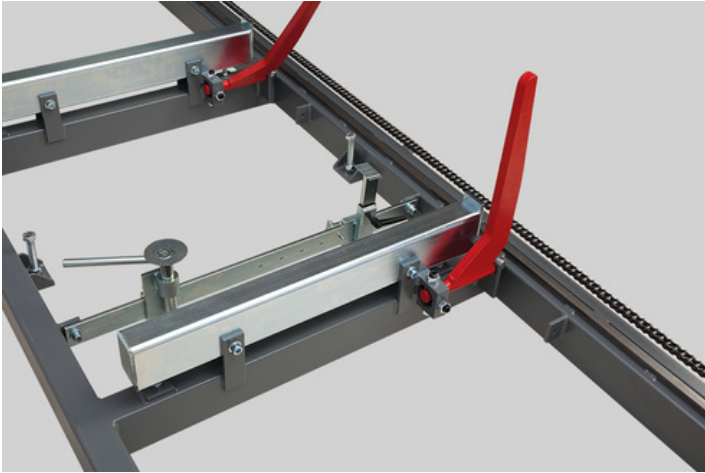
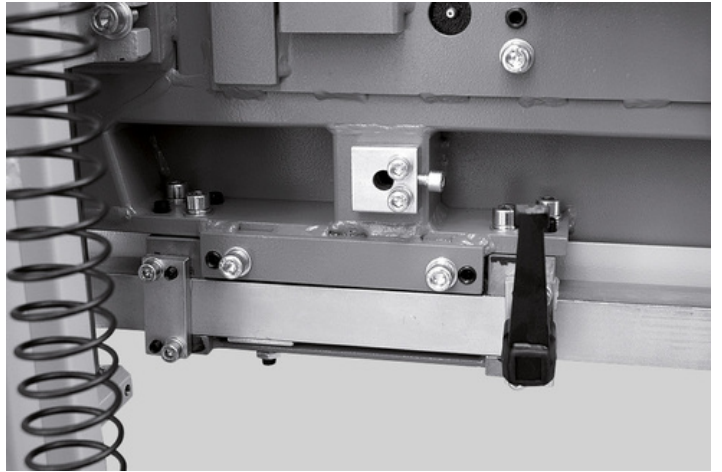
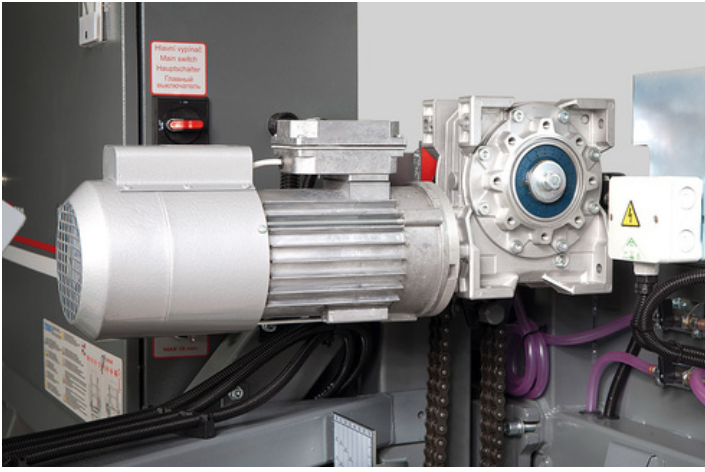

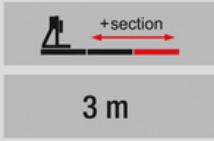

**Extending section
3m**

Extending section 3 m

Include: 3x Cross beams, 2x Tilting angle bars
Variable points: 3x clamps



Main motor 11 kW

Main motor 11 kW

For even higher performance, for example, when cutting oversized logs or even when cutting very hard materials, especially with Stellite-tipped blades an 11 kW motor can be recommended.



Main motor 15 kW

Main motor 15 kW

For even higher performance, for example, when cutting oversized logs or even when cutting very hard materials, especially with Stellite-tipped blades 15 kW motor can be recommended.



Debarker 800

Debarker

Debarker with hard metal tips is designed to remove dirt at points where the saw blade cuts into the log. The saw blade do not get blunt quickly. Frequent saw blade exchanges are reduced, the saw blade life, and the productivity of the machine increase.

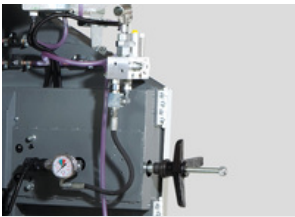

Hydraulic saw blade tensioner 800

Hydraulic saw blade tensioner

Operated by a hydraulic hand pump with accurate pressure indication. The hydraulic saw blade tensioner is more accurate and convenient.



Ammeter - blade load indicator

Ammeter - blade load indicator

The ammeter scale shows the saw blade engine load during the cut. It is designed to simplify the selection of the feed speed; it also indicates the saw blade bluntness. A timely exchange of the saw blade increases the life-span and improves the cutting quality.



Soft starter - smooth blade start-up

Soft starter - smooth blade start-up

Electronic device enabling a smooth start-up of the saw blade motor. It prevents grid surges reducing mechanical stress of the whole machine.

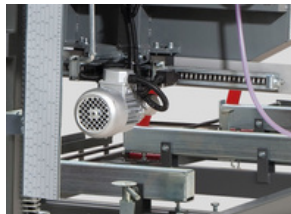

Electrically controlled guide bar 800

Electrically controlled guide bar

Adjustment of sliding guide bar of the saw blade depending on the log diameter electrically controlled from the central control desk.



Laser Sight

Laser Sight LAS

Laser aiming is a very practical helper for axial alignment of the log before the cutting. The cutting level shows a line copying the path of the saw blade.



Cant hook

Gancho volteador

Se utiliza para girar, rodar y manipular troncos. La punta puede usarse para separar troncos o clavarse en el suelo para proporcionar estabilidad durante el trabajo. El gancho volteador se fabrica en longitudes de 79 cm y 125 cm (incluida la punta).



Cam Dog Kit

Cam Dog Kit

Consists of a rail and a front and rear clammer/dog.

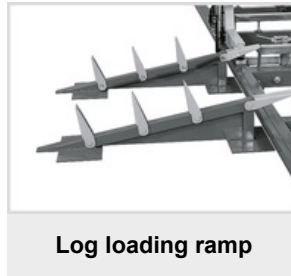

Log loading ramp

Log loading ramp

Provides easy and safe manipulation on machine cross beams with system of flexible stops.



START/STOP cooling system

START/STOP cooling system

Integrated in the cooling system is an electromagnetic through-flow valve, which automatically opens when the saw blade is started and closes when the saw blade is stopped. It substantially lowers the coolant consumption and saves time needed for replenishment of coolant liquid.



START/STOP pressure cooling system

Double sided START/STOP pressure cooling system

The cooling system consists of a pressure pump in the coolant tank, flow control solenoid valve and two-way jets that spray the sawmill blade both from below and from above. Double-side cooling prevents undesirable stress in the saw band and adhesion of resin from underneath the sawmill blade and thus helps maintain stabler sawmill blade operation, more accurate cut and longer service life. Integrated in the cooling system is an electromagnetic through-flow valve, which automatically opens when the saw blade is started and closes when the saw blade is stopped. It substantially lowers the coolant consumption and saves time needed for replenishment of coolant liquid.



ARCTIC

ARCTIC

Version of the machine adapted for work in extremely cold operating temperatures reaching down to - 40 °C. Machine's switch board, control panel and digital measuring are fitted with heating elements. The heating is controlled through a thermostat. Frost-resistant lubricant. Band sawmills use frost-resistant hydraulic oil.



LED lighting

LED lighting

Good quality lightening of the workspace using two powerful LED strips mounted on a movable bridge.



Grease Gun

Grease Gun

For regular maintenance of the machine according to the lubrication plan. Metal grease gun for 400g tubes. Equipped with a flexible pressure hose.

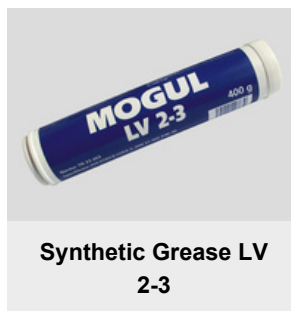

Synthetic Grease LV 2-3

Synthetic Grease LV 2-3

400g tube for the grease gun.

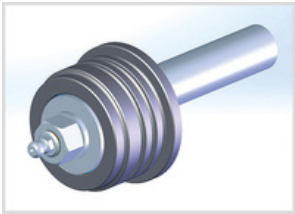

**Blade Roller Kit VK
35**

Blade Roller Kit VK 35
Hardened roller, bearings, and shaft
designed for a sawmill blade 35 mm.

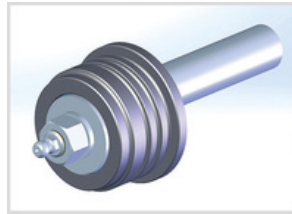

**Blade Roller Kit VK
40**

Blade Roller Kit VK 40
Hardened roller, bearings, and shaft
designed for a sawmill blade 40 mm.

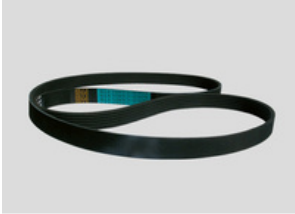

**Wheel Flat Belt GPK
1885**

Flat running wheel belt GPK 1885

